

API 6A TYPE 6B

Nominal pipe size		Outside Diameter (O)	Thickness (C)	Length Thru Hub (Y)	Bolt Circle	No. & Size of Holes	Groove Dimension of Ring Joint Face						Appro. Weights (kg)		Nominal pipe size		
							Pitch Dia of Groove	Width of Groove	Depth of Groove	Radius of Groove Bottom	OD of Raised face	Ring No.	WN	BL			
in	mm	mm	mm	mm	mm	mm	mm	mm	mm	mm	mm					in	mm
3000LB FLANGES																	
2.½	52.4	216.0	46.0	109.5	165.1	8 ; 26.0	95.25	11.91	7.94	0.79	124.0	R24	11	10	2.½	52.4	
3.½	79.4	241.0	46.0	109.5	190.5	8 ; 29.0	123.83	11.91	7.94	0.79	156.0	R31	20	19	3.½	79.4	
4.½	103.2	292.0	52.4	122.2	235.0	8 ; 32.0	149.23	11.91	7.94	0.79	181.0	R37	30	30	4.½	103.2	
5.½	130.2	349.0	58.7	134.9	279.4	8 ; 35.0	180.98	11.91	7.94	0.79	216.0	R41	57	58	5.½	130.2	
7.½	179.4	381.0	63.5	147.6	317.5	12 ; 32.0	211.14	11.91	7.94	0.79	241.0	R45	70	72	7.½	179.4	
5000LB FLANGES																	
2.½	52.4	216.0	46.0	109.5	165.1	8 ; 26.0	95.25	11.91	7.94	0.79	124.0	R24	11	10	2.½	52.4	
3.½	79.4	267.0	55.6	125.4	203.2	8 ; 32.0	136.53	11.91	7.94	0.79	168.0	R35	20	19	3.½	79.4	
4.½	103.2	311.0	61.9	131.8	241.3	8 ; 35.0	161.93	11.91	7.94	0.79	194.0	R39	30	30	4.½	103.2	
5.½	130.2	375.0	81.0	163.5	292.1	8 ; 42.0	193.68	11.91	7.94	0.79	229.0	R44	57	58	5.½	130.2	
7.½	179.4	394.0	92.1	181.0	317.5	12 ; 39.0	211.14	13.40	9.53	1.59	248.0	R46	70	72	7.½	179.4	

**ASTM GROUP 2-1.1 MATERIALS
WORKING PRESSURE BY CLASSES, BAR**

Temp -29 °C	150	300	400	600	900	1500	2500
38	19.6	51.1	68.1	102.1	153.2	255.3	425.5
50	19.2	50.1	66.8	100.2	150.4	250.6	417.7
100	17.7	46.6	62.1	93.2	139.8	233	388.3
150	15.8	45.1	60.1	90.2	135.2	225.4	375.6
200	13.8	43.8	58.4	87.6	131.4	219	365
250	12.1	41.9	55.9	83.9	125.8	209.7	349.5
300	10.2	39.8	53.1	79.6	119.5	199.1	331.8
325	9.3	38.7	51.6	77.4	116.1	193.6	322.6
350	8.4	37.6	50.1	75.1	112.7	187.8	313
375	7.4	36.4	48.5	72.7	109.1	181.8	303.1
400	6.5	34.7	46.3	69.4	104.2	173.6	289.3
425	5.5	28.8	38.4	57.5	86.3	143.8	239.7
450	4.6	23	30.7	46	69	115	191.7
475	3.7	17.4	23.2	34.9	52.3	87.2	145.3
500	2.8	11.8	15.7	23.5	35.3	58.8	97.9
538	1.4	5.9	7.9	11.8	17.7	29.5	49.2

**ASTM GROUP 2-2.3 MATERIALS
WORKING PRESSURE BY CLASSES, BAR**

Temp -29 °C	150	300	400	600	900	1500	2500
38	15.9	41.4	55.2	82.7	124.1	206.8	344.7
50	15.3	40	53.4	80	120.1	200.1	333.5
100	13.3	34.8	46.4	69.6	104.4	173.9	289.9
150	12	31.4	41.9	62.8	94.2	157	261.6
200	11.2	29.2	38.9	58.3	87.5	145.8	243
250	10.5	27.5	36.6	54.9	82.4	137.3	228.9
300	10	26.1	34.8	52.1	78.2	130.3	217.2
325	9.3	25.5	34	51	76.4	127.4	212.3
350	8.4	25.1	33.4	50.1	75.2	125.4	208.9
375	7.4	24.8	33	49.5	74.3	123.8	206.3
400	6.5	24.3	32.4	48.6	72.9	121.5	202.5
425	5.5	23.9	31.8	47.7	71.6	119.3	198.8
450	4.6	23.4	31.2	46.8	70.2	117.1	195.1

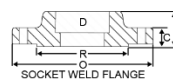
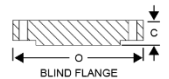
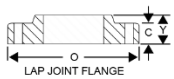
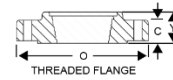
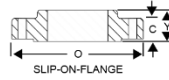
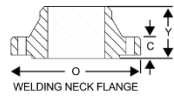

150 LB. FLANGES

Nominal pipe size	Outside Diameter (O)	Thickness (C)	OD of Raised Face (R)	Length Thru Hub (Y)			Depth of Socket (D)	Bolt Circle	No. & Size of Holes	RTJ Ring No.	Appro. Weights (kg)					Nominal pipe size		
				WN	LJ	SO, SW, TH					WN	SO/TH	BL	LJ	SW	in	mm	
1/2	15	88.9	11.1	34.9	47.6	15.9	15.9	9.5	60.3	4 ; 15.9	-	0.48	0.39	0.42	0.38	0.42	1/2	15
3/4	20	98.4	12.7	42.9	52.4	15.9	15.9	11.1	69.8	4 ; 15.9	-	0.71	0.56	0.61	0.55	0.59	3/4	20
1	25	107.9	14.3	50.8	55.6	17.5	17.5	12.7	79.4	4 ; 15.9	R15	1.01	0.78	0.86	0.76	0.81	1	25
1 1/4	32	117.5	15.9	63.5	57.1	20.6	20.6	14.3	88.9	4 ; 15.9	R17	1.33	1.03	1.17	1.01	1.07	1 1/4	32
1 1/2	40	127.0	17.5	73.0	61.9	22.2	22.2	15.7	98.4	4 ; 15.9	R19	1.72	1.32	1.53	1.30	1.36	1 1/2	40
2	50	152.4	19.1	92.1	63.5	25.4	25.4	17.5	120.6	4 ; 19.0	R22	2.58	2.06	2.42	2.03	2.10	2	50
2 1/2	65	177.8	22.2	104.8	69.8	28.6	28.6	19.1	139.7	4 ; 19.0	R25	4.11	3.28	3.94	3.25	3.33	2 1/2	65
3	80	190.5	23.8	127.0	69.8	30.2	30.2	20.6	452.4	4 ; 19.0	R29	4.92	3.85	4.93	3.81	3.90	3	80
3 1/2	90	215.9	23.8	139.7	71.4	31.7	31.7	-	177.8	8 ; 19.0	R33	6.08	4.81	6.17	4.76	-	3 1/2	90
4	100	228.6	23.8	157.2	76.2	33.3	33.3	-	190.5	8 ; 19.0	R36	6.84	5.30	7.00	5.25	-	4	100
5	125	254.0	23.8	185.7	88.9	36.5	36.5	-	215.9	8 ; 22.2	R40	8.56	6.07	8.63	6.02	-	5	125
6	150	279.4	25.4	215.9	88.9	39.7	39.7	-	241.3	8 ; 22.2	R43	10.6	7.45	11.3	7.40	-	6	150
8	200	342.9	28.6	269.9	101.6	44.4	44.4	-	298.4	8 ; 22.2	R48	17.6	12.1	19.6	12.1	-	8	200
10	250	406.4	30.2	323.8	101.6	49.2	49.2	-	361.9	12 ; 25.4	R52	24.0	16.5	28.8	16.4	-	10	250
12	300	482.6	31.8	381.0	114.3	55.6	55.6	-	431.8	12 ; 25.4	R56	36.5	26.2	43.2	26.1	-	12	300
14	350	533.4	34.9	412.7	127.0	79.4	79.4	-	476.2	12 ; 28.6	R59	48.4	34.6	58.1	34.5	-	14	350
16	400	596.9	36.5	469.9	127.0	87.3	87.3	-	539.7	16 ; 28.6	R64	60.6	44.8	76.0	44.6	-	16	400
18	450	635.0	39.7	533.4	139.7	96.8	96.8	-	577.8	16 ; 31.7	R68	68.3	48.9	93.7	48.7	-	18	450
20	500	698.5	42.9	584.2	144.5	103.2	103.2	-	635.0	20 ; 31.7	R72	64.5	61.9	122	61.6	-	20	500
22	550	749.3	46.0	641.3	149.2	108.0	108.0	-	692.1	20 ; 34.9	R80	102	72.1	151	79.8	-	22	550
24	600	812.8	47.6	692.1	152.4	111.1	111.1	-	749.3	20 ; 34.9	R76	115	86.9	185	86.6	-	24	600

300 LB. FLANGES

Nominal pipe size	Outside Diameter (O)	Thickness (C)	OD of Raised Face (R)	Length Thru Hub (Y)			Depth of Socket (D)	Bolt Circle	No. & Size of Holes	RTJ Ring No.	Appro. Weights (kg)					Nominal pipe size		
				WN	LJ	SO, SW, TH					WN	SO/TH	BL	LJ	SW	in	mm	
1/2	15	95.2	14.3	34.9	52.4	22.2	22.2	9.5	66.7	4 ; 15.9	R11	0.75	0.64	0.64	0.62	0.66	1/2	15
3/4	20	117.5	15.9	42.9	57.1	25.4	25.4	11.1	82.5	4 ; 19.0	R13	1.26	1.12	1.11	1.10	1.15	3/4	20
1	25	123.8	17.5	50.8	61.9	27.0	27.0	12.7	88.9	4 ; 19.0	R16	1.52	1.36	1.39	1.33	1.40	1	25
1 1/4	32	133.3	19.0	63.5	65.1	27.0	27.0	14.3	98.4	4 ; 19.0	R18	2.03	1.68	1.79	1.65	1.75	1 1/4	32
1 1/2	40	155.6	20.6	73.0	68.3	30.2	30.2	15.9	114.3	4 ; 22.2	R20	2.89	2.49	2.66	2.44	2.55	1 1/2	40
2	50	165.1	22.2	92.1	69.8	33.3	33.3	17.5	127.0	8 ; 19.0	R23	3.40	2.87	3.18	2.83	2.93	2	50
2 1/2	65	190.5	25.4	104.8	76.2	38.1	38.1	19.0	149.2	8 ; 22.2	R26	5.17	4.32	4.85	4.25	4.40	2 1/2	65
3	80	209.5	28.6	127.0	79.4	42.9	42.9	20.6	168.3	8 ; 22.2	R31	6.93	5.85	6.81	5.78	5.92	3	80
3 1/2	90	228.6	30.2	139.7	81.0	44.4	44.4	-	184.1	8 ; 22.2	R34	8.67	7.34	8.71	7.27	-	3 1/2	90
4	100	254.0	31.8	157.2	85.7	47.6	47.6	-	200.0	8 ; 22.2	R37	11.2	9.61	11.5	9.55	-	4	100
5	125	279.4	34.9	185.7	98.4	50.8	50.8	-	234.9	8 ; 22.2	R41	15.8	12.3	15.6	12.2	-	5	125
6	150	317.5	36.5	215.9	98.4	52.4	52.4	-	269.9	12 ; 22.2	R45	19.1	15.6	20.9	15.5	-	6	150
8	200	381.0	41.3	269.9	111.1	61.9	61.9	-	330.2	12 ; 25.4	R49	29.9	24.2	34.3	24.1	-	8	200
10	250	444.5	47.6	323.8	117.5	95.2	95.2	-	387.3	16 ; 28.6	R53	42.7	34.1	53.3	34.4	-	10	250
12	300	520.7	50.8	381.0	130.2	101.6	101.6	-	450.8	16 ; 31.7	R57	61.8	49.8	78.8	50.4	-	12	300
14	350	584.2	54.0	412.7	142.9	111.1	111.1	-	514.3	20 ; 31.7	R61	85.8	69.9	105	70.9	-	14	350
16	400	647.7	57.2	469.9	146.0	120.6	120.6	-	571.5	20 ; 34.9	R65	106	88.1	137	89.5	-	16	400
18	450	711.2	60.3	533.4	158.7	130.2	130.2	-	628.6	24 ; 34.9	R69	131	109	175	111	-	18	450
20	500	774.7	63.5	584.2	161.9	139.7	139.7	-	685.8	24 ; 34.9	R73	158	134	221	137	-	20	500
24	600	914.4	69.8	692.1	168.3	152.4	152.4	-	812.8	24 ; 41.3	R77	230	201	339	204	-	24	600